

Hinge Adjustments

CLIP Top series 170° hinges

Side Adjustment

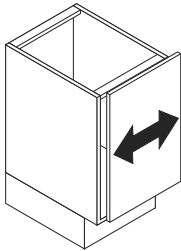

Turn front screw counter-clockwise to increase door overlay, clockwise to decrease.
Range = $\frac{5}{32}$ " (4mm)

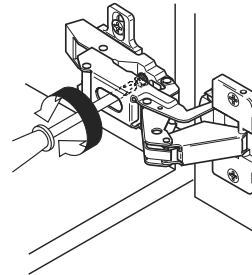

Depth Adjustment

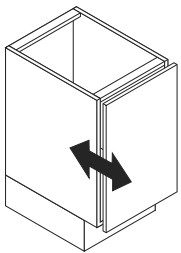

Rotate back screw to adjust door position.
Range = $\frac{3}{16}$ " (5mm)

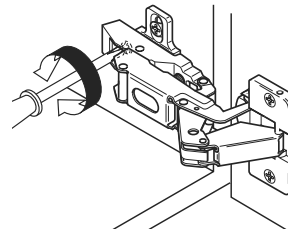

Height Adjustment

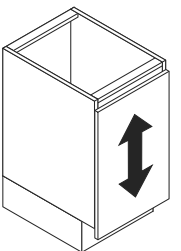

Loosen screw(s) on the mounting plate. Adjust door to position and tighten screws.
Range = $\frac{5}{32}$ " (4mm)

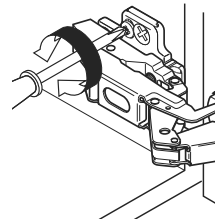

Two-piece mounting plate

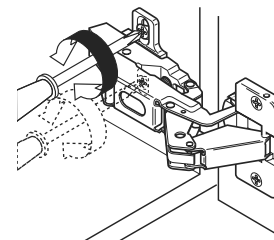

One-piece mounting plate

Door Removal and Installation

Release the lever under the hinge arm to remove.

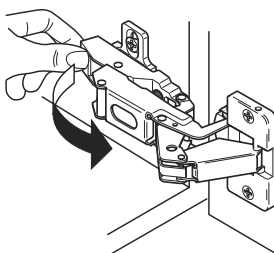

To reinstall, place the hinge on the mounting plate and push the back with finger pressure. The "CLIP" sound confirms a secure attachment.

